

MODEL XL-75 DIAGRAM WITH SOUNDBAR MOUNT

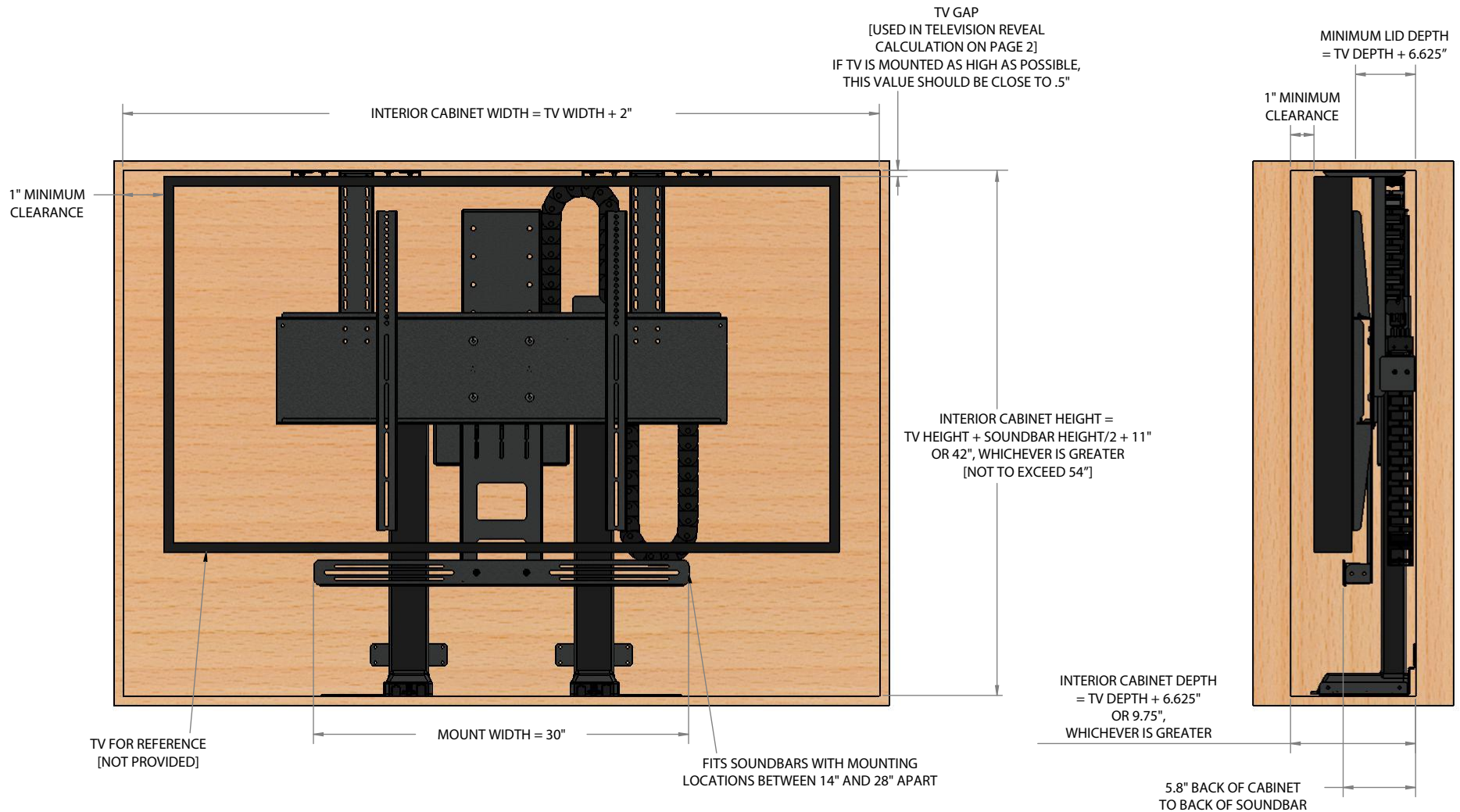

NOTES:

1. THE CABINET BOX SHOWN IN THE DIAGRAM IS FOR REFERENCE ONLY AND IS NOT PROVIDED WITH THE LIFT SYSTEM
2. FOR THIS LIFT MODEL, THE LENGTH OF ITS TRAVEL [EXTENSION LENGTH OR STROKE] IS 64"
3. FOR THIS LIFT MODEL, THE TOTAL WEIGHT CAPACITY IS 130 LBS
4. HEIGHT OF THIS MODEL IS ADJUSTABLE IN 1/4" INCREMENTS [MINIMUM HEIGHT = 42"; MAXIMUM HEIGHT = 53.75"]
5. WHEN INSTALLED IN THE FLOOR, THE LID MUST BE SUPPORTED BY CATCHES
6. THE LIFT MUST BE FASTENED TO THE FLOOR AND REAR WALL OF THE ENCLOSURE FOR OPTIMAL STABILITY AND SAFETY
7. LID IS DESIGNED TO FLOAT WITH PROVIDED TAPERED PINS - LID MUST BE REMOVEABLE FOR SAFETY
8. WHEN DETERMINING TV HEIGHT, ALWAYS USE MANUFACTURER SUPPLIED "TV WITHOUT STAND" HEIGHT
9. LIFT MECHANISM IS POWDERCOATED BLACK STEEL. COLORS IN DIAGRAM ARE FOR CLARITY ONLY.

NEXUS 21

TECHNOLOGY IN MOTION

COPYRIGHT 2017 - ALL RIGHTS RESERVED
UPDATED 11/20/17

MODEL XL-75 DIAGRAM WITH SOUNDBAR MOUNT

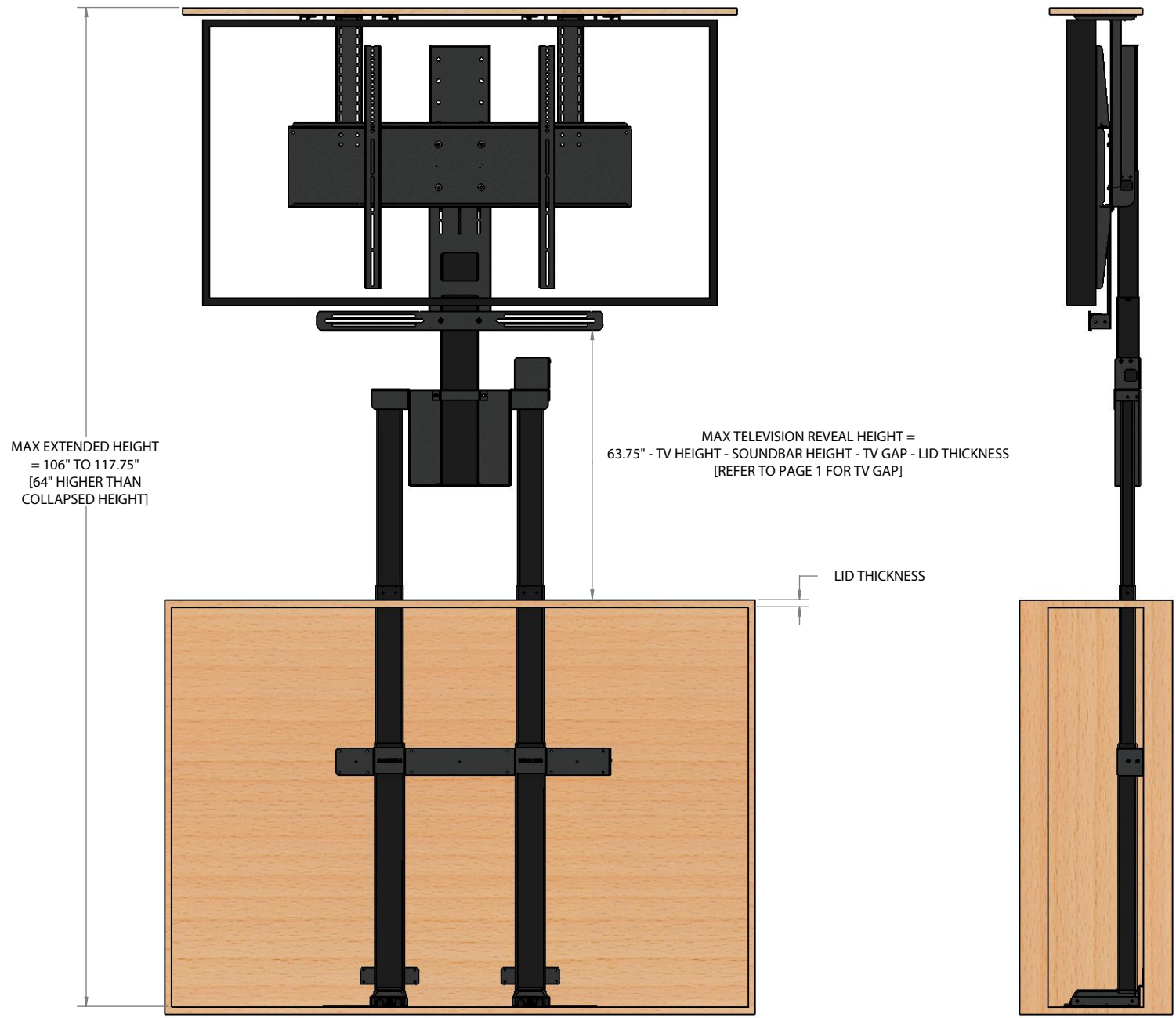

NEXUS 21

TECHNOLOGY IN MOTION

COPYRIGHT 2017 - ALL RIGHTS RESERVED
UPDATED 11/20/17