

MODEL L-50 DIAGRAM W/ CENTER SPEAKER SHELF - PRIMARY CABINET DIMENSIONS

SPECIFICATIONS (CENTIMETERS ARE REPRESENTED BY [])

MAX TV SIZE : 65"
 MAX WEIGHT CAPACITY : 100 LBS [45.4 KG]
 MAX TRAVEL (EXTENSION) : 39.25" [99.7]
 LIFT SYSTEM HEIGHT : 28.5" [72.4] TO 40.5" [102.9]
 MAX TV + COMPONENT HEIGHT : 38" [96.5] MINUS LID THICKNESS

QUICK REFERENCE DIMENSION GUIDE (USE WHICHEVER IS GREATER)

TV DIMENSIONS : W____, H____, D____
 SPEAKER DIMENSIONS : SW____, SH____, SD____
 MIN. INTERIOR CABINET WIDTH : $W+2"$ [5.1] = ____ OR $SW+2"$ [5.1] = ____ OR 34" [86.4]
 MIN. LID CUTOUT WIDTH : _____
 MIN. INTERIOR CABINET HEIGHT : $H+SH+2"$ [5.1] = ____ OR 30.5" [77.5]
 MIN. INTERIOR CABINET DEPTH : $D+6"$ [15.2] = ____ OR $SD+5.5"$ [14] = ____ OR 10.5" [26.7]
 MIN. LID CUTOUT DEPTH : _____

MIN. INTERIOR CABINET WIDTH = TV WIDTH + 2" [5.1], SPEAKER WIDTH + 2" [5.1] OR 34" [86.4] WHICHEVER IS GREATER

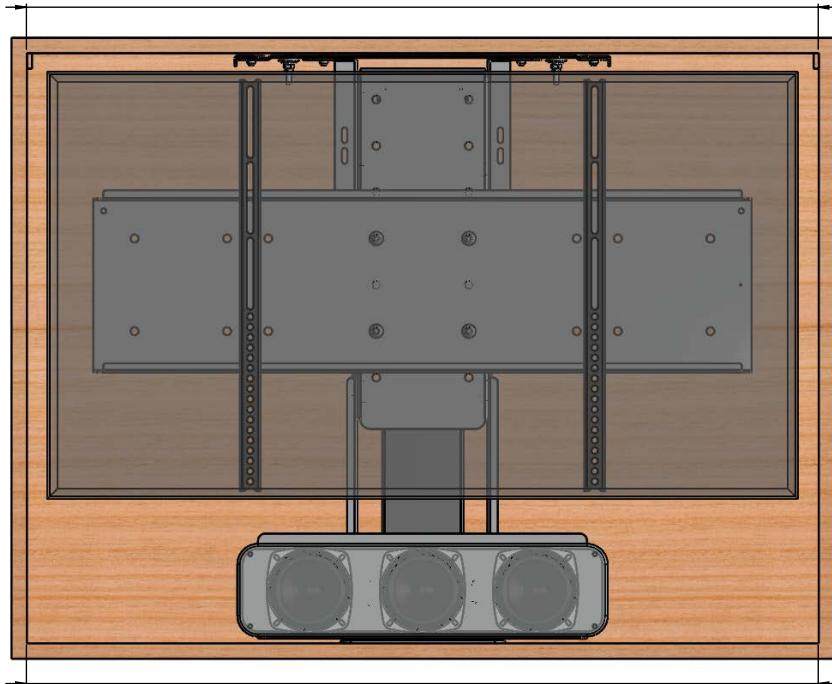

MIN. INTERIOR CABINET WIDTH = TV WIDTH + 2" [5.1] OR SPEAKER WIDTH + 2" [5.1] OR 34" [86.4], WHICHEVER IS GREATER

MIN. LID CUTOUT DEPTH = TV DEPTH + 6" [15.2] OR SPEAKER DEPTH + 5.5" [14] OR 10.5" [26.7] WHICHEVER IS GREATER

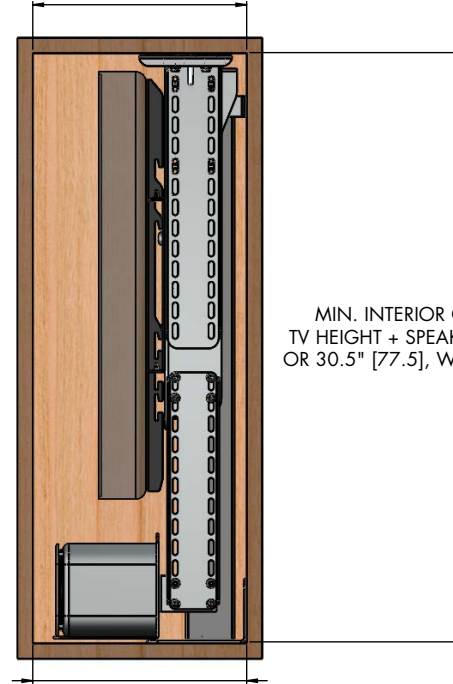

MIN. INTERIOR CABINET HEIGHT = TV HEIGHT + SPEAKER HEIGHT + 2" [5.1] OR 30.5" [77.5], WHICHEVER IS GREATER

MIN. INTERIOR CABINET DEPTH = TV DEPTH + 6" [15.2] OR SPEAKER DEPTH + 5.5" [14] OR 10.5" [26.7] OR WHICHEVER IS GREATER

NOTES:

1. THE CABINET BOX SHOWN IN THE DIAGRAM IS FOR REFERENCE ONLY AND IS NOT PROVIDED WITH THE LIFT SYSTEM
2. WHEN DETERMINING TV HEIGHT, ALWAYS USE MANUFACTURER SUPPLIED "TV WITHOUT STAND" HEIGHT
3. LIFT MECHANISM IS POWDERCOATED BLACK STEEL, COLORS IN DIAGRAM ARE FOR CLARITY ONLY

NEXUS₂₁

COPYRIGHT 2019 - ALL RIGHTS RESERVED
UPDATED 11/20/19

MODEL L-50 DIAGRAM W/ CENTER SPEAKER SHELF - CABINET REFERENCE DIMENSIONS

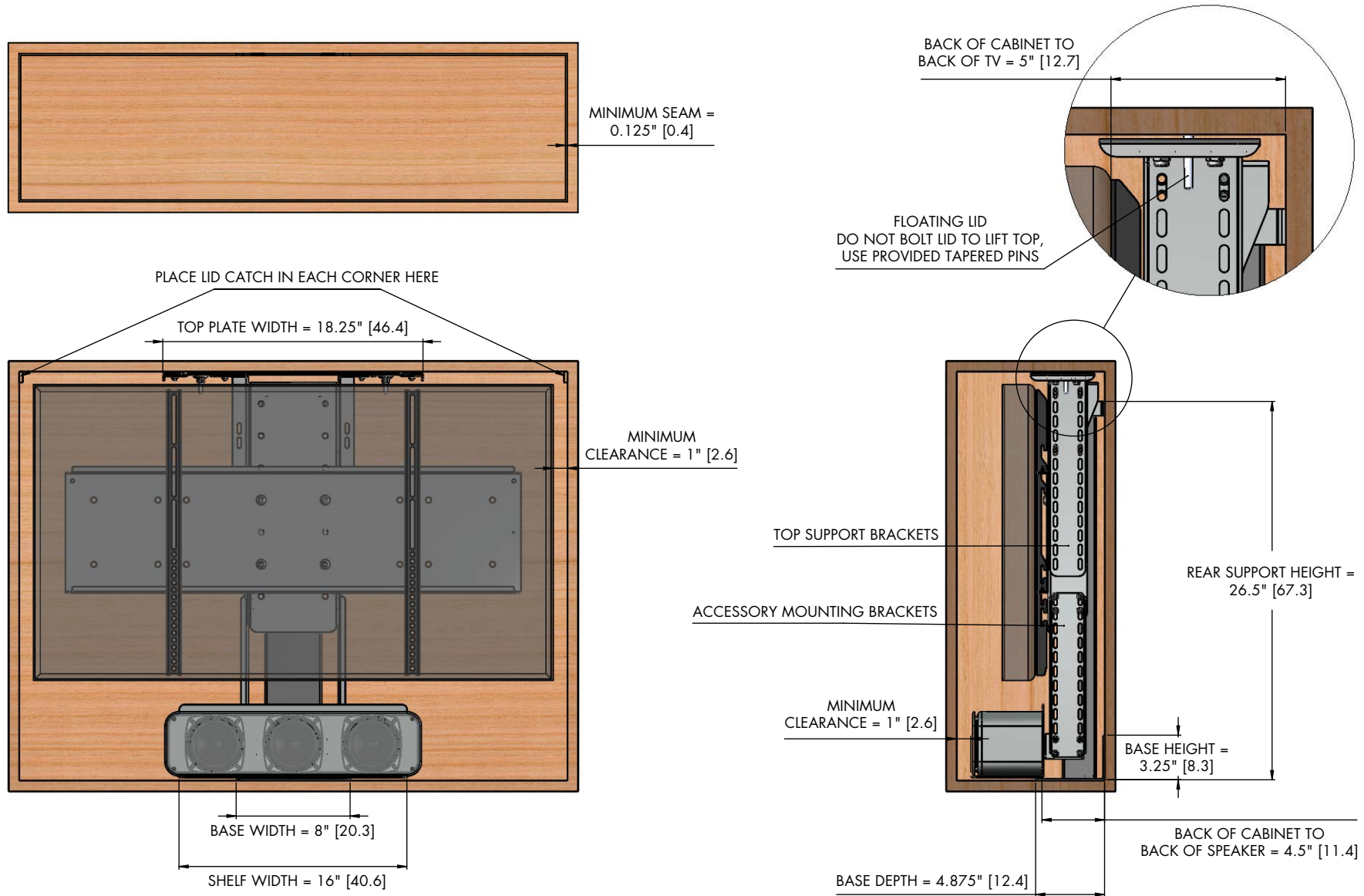

- NOTES:
1. TOP SUPPORT BRACKETS ALLOW TOP PLATE TO BE ADJUSTED FLUSH WITH UNDERSIDE OF LID
 2. ACCESSORY MOUNTING BRACKETS ALLOW COMPONENT SHELF TO BE ADJUSTED CLOSE TO UNDERSIDE OF TV
 3. TAPERED PINS ALLOW LID TO FLOAT WITH THE USE OF LID CATCHES.
 4. MINIMUM SEAM CAN BE REDUCED TO 0.0625" [0.2] WITH A 45 DEGREE BEVEL ON THE LID